



# VILLA B4

Villa 3 storey, 4 bedrooms 576 → 624 m<sup>2</sup>

- infinity pool
- well-equipped kitchen
- private deep well water
- electricity by government

## Optional equipment

- Indoor and outdoor furniture
- Layout of the multipurpose room (cinema room, recreation room, ...)

### Ground floor :

- Parking 26 m<sup>2</sup>
- Entrance 21 m<sup>2</sup>
- Living, Dinning & Kitchen 67.5 m<sup>2</sup>
- Bedroom 2 23.5 m<sup>2</sup>
- Walk-in Closet 6 m<sup>2</sup>
- En-suite Bathroom 8.5 m<sup>2</sup>
- Terrace 66 m<sup>2</sup>
- Swiming pool 32 m<sup>2</sup>

### Second floor :

- Bedroom 1 27 m<sup>2</sup>
- En-suite Bathroom 8 m<sup>2</sup>
- En-suite Terrace 13 m<sup>2</sup>
- Bedroom 3 17 m<sup>2</sup>
- En-suite Bathroom 14.5 m<sup>2</sup>
- En-suite Terrace 8 m<sup>2</sup>
- Bedroom 4 18 m<sup>2</sup>
- En-suite Bathroom 12.5 m<sup>2</sup>
- En-suite Terrace 5.5 m<sup>2</sup>

### Basement floor :

- Multipurpose room 79.5 m<sup>2</sup>
- Storage / Bedroom 5 45 m<sup>2</sup>
- Laundry 9.5 m<sup>2</sup>
- Pump room 7 m<sup>2</sup>

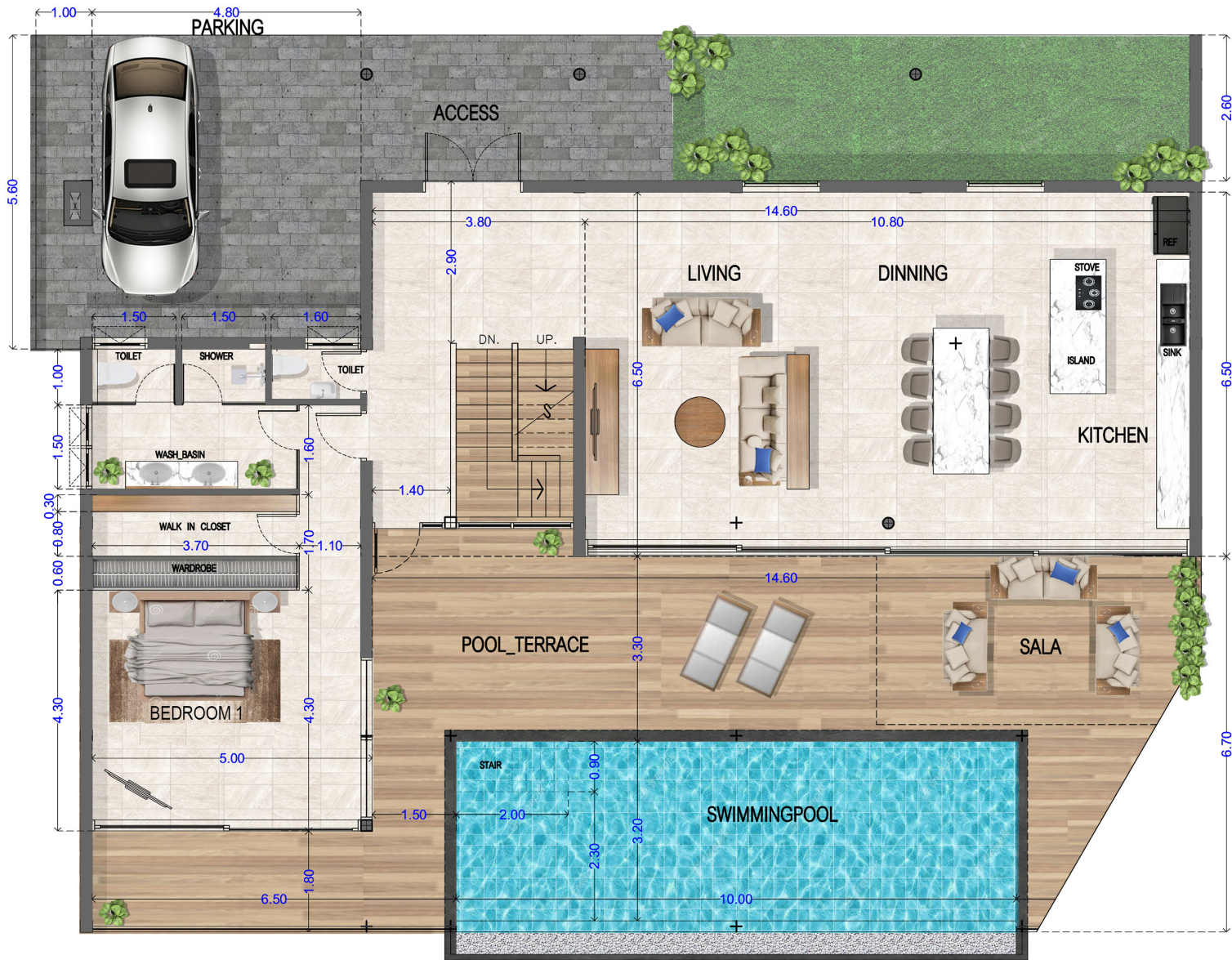

**VILLAS B4 - GROUND FLOOR**

INTERNAL	143 sqm
EXTERNAL	140 sqm
GROUND FLOOR AREA	283 sqm
TOTAL HOUSE AREA	576 sqm





**VILLAS B4 - SECOND FLOOR**

INTERNAL	136 sqm
EXTERNAL	27 sqm
SECOND FLOOR AREA	163 sqm
TOTAL HOUSE AREA	576 sqm



**VILLAS B4 - BASEMENT**

INTERNAL	131 sqm
EXTERNAL	0 sqm
BASEMENT AREA	131 sqm
TOTAL HOUSE AREA	576 sqm



**VILLAS B4 - BASEMENT**

INTERNAL	179 sqm
EXTERNAL	0 sqm
BASEMENT AREA	179 sqm
TOTAL HOUSE AREA	624 sqm





**VILLAS B4 - BASEMENT**

INTERNAL	179 sqm
EXTERNAL	0 sqm
BASEMENT AREA	179 sqm
TOTAL HOUSE AREA	624 sqm